



A Donaldson Company

A WORLD LEADER IN FUME
EXTRACTION TECHNOLOGY

V 350E

Last Updated on 02.02.2022



Entry-level dual-arm fume extraction system for electronics hand soldering processes.

The V 350E extraction unit is a compact, low-cost system that is capable of generating high airflow rates from a range of benchtop attachments.

The extraction unit can be positioned comfortably under a bench with a simple installation kit to connect to the most suitable extraction accessory.

Technology



Advanced carbon
filter (ACF)
technology



ProTECT service
plan



SureCHECK
quality standard

Key features of the V 350E

Simple installation

Standard

2 x 75mm x 1m 'stay-put' arm with funnel

Optional

High air flow rates

Standard

2 x 75mm 'stay-put' hose with funnel and table mount kit

Optional

Contact BOFA at <https://bofainternational.com/en/contact/>

<https://bofainternational.com/en/portal/datasheets/v-350e/>



Approvals: REACH and RoHS. See individual product technical data for specific accreditations

Technical specification

1. Power cable inlet

2. On / off switch

3. Filter latch

4. Hose inlet connection - 2 x 75mm

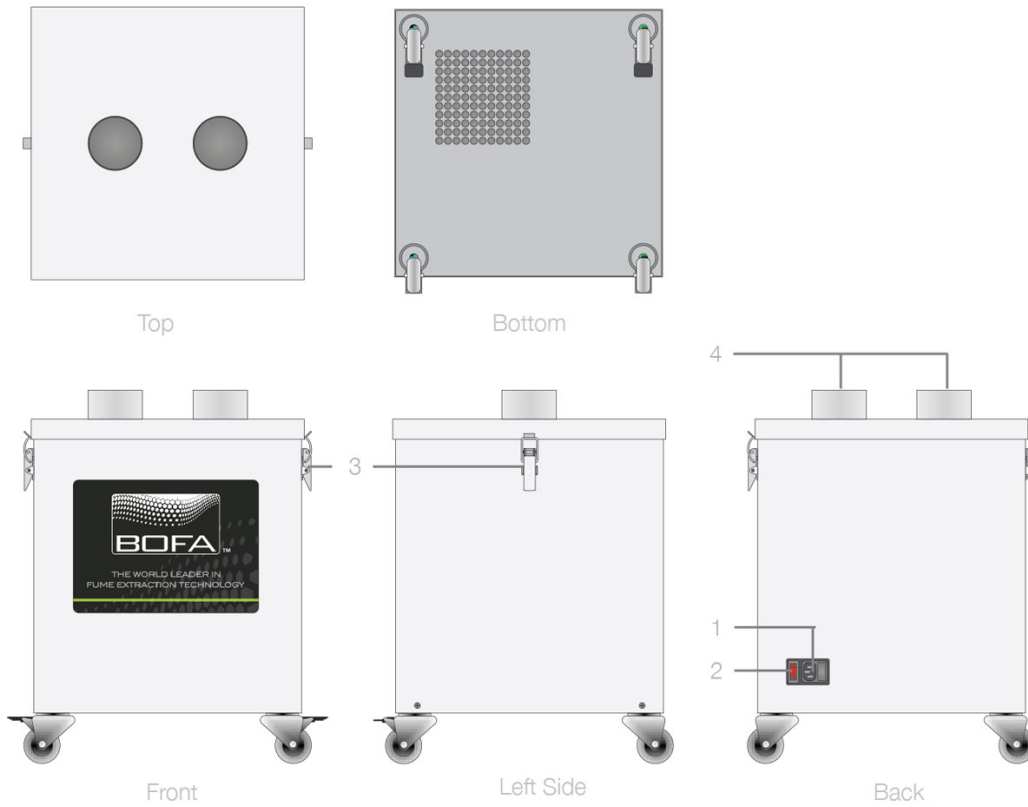

Airflow through filters

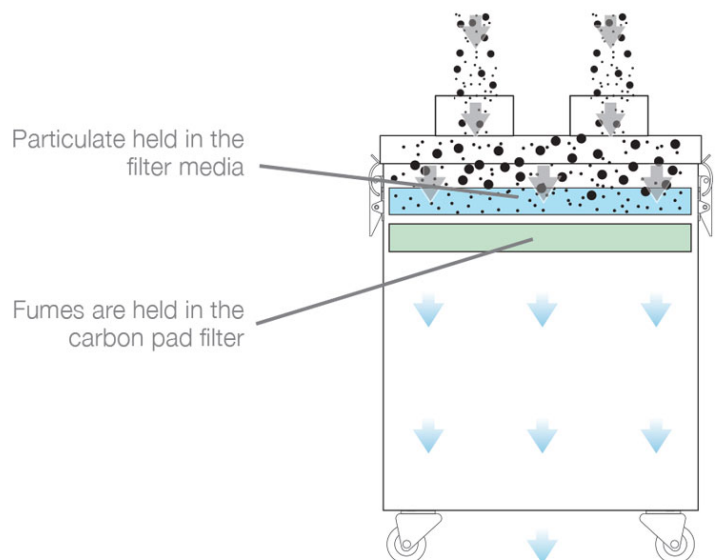
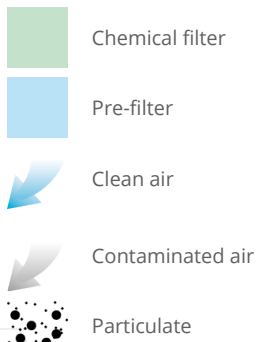

Technical data

	EU	US
Dimensions (HxWxD)	517 x 370 x 370mm	20.35 x 14.56 x 14.56"
Cabinet construction	Powder coated mild steel	Powder coated mild steel
Airflow / pressure	540m ³ /hr / 4mbar	317cfm / 4mbar
Electrical data	230v 50/60Hz full load current: 1.1 amps / 0.25kw	115v 50/60Hz full load current: 2.1 amps / 0.255kw
Noise level	< 60dBA (at typical operating speed)	< 60dBA (at typical operating speed)
Weight	18kg	39.7lbs
Duct size	2 x 75mm	2 x 3"
Max duct run	6mtrs	19.7ft
Gas filter	Carbon sponge pad	Carbon sponge pad
Pre-filter efficiency	M6	M6
Approvals	UKCA and CE	UKCA and CE

Unit specifications

	EU	US
Maximum number of 75mm arms, cowls or down draft trays	2	2

Unit part numbers

Model	Description	Voltage	Part number
V 350E Powder coated	Unit only (no install kit)	230v	E1042A0000
V 350E Powder coated	Unit only (no install kit)	115v	E1041A0000

Replacement filter part numbers

Description	Part number
Filter set	A1030110



Arm accessories



Hose kits and replacement arm part numbers

Number reference	Description	Part number
1	75mm diameter stay put arm with funnel 1m long	A1020042
2	Table bracket	A1020077
3	1.5m of 75mm flex with jubilee clip	A1020425

Other hose kits and filters are available.

Datasheet correct at time of publishing.

Where applicable, the carbon used in BOFA units is capable of removing a wide range of VOCs, however it is the responsibility of the user to ensure the carbon is suitable for their application. For specific applications, please contact us for details.

Important Notice: Many factors beyond the control of BOFA can affect the use and performance of BOFA products in a particular application, including the conditions under which the product is used. Since these factors are uniquely within the user's knowledge and control, it is essential the user evaluate the products to determine whether the product is fit for the particular purpose and suitable for the user's application. All products, product specifications, availability and data are subject to change without notice, and may vary by region or country.

Think before you print! Please consider the environment before printing this document.

